

LUDF Soil Types

Milking Platform - North & South Block						
Family /Sibling	Soil Classification	Soil Profile Material	Profile Texture	Location	Area - ha	Percentage
Eyre_1a.1	Weathered Orthic Recent Soils (ROW)	Rounded stony soil	Silt	Both	3.75	2%
Eyre_3a.1	Weathered Orthic Recent Soils (ROW)	Rounded stony soil	Silt	Both	1.3	1%
Templeton_2a.1	Weathered Orthic Recent Soils (ROW)	Rounded stony soil	Silt	Both	8	5%
Templeton_4a.1	Typic Immature Pallic Soils (PIT)	Moderately deep soil	Silt	Both	9	6%
Wakanui_1a.1	Typic Immature Pallic Soils (PIT)	Moderately deep soil	Silt	Both	25	16%
Wakanui_21a.1	Mottled Immature Pallic Soils (PIM)	Stonless Soil	Silt	Both	11	7%
Wakanui_3a.1	Mottled Immature Pallic Soils (PIM)	Moderately deep soil	Silt over sand	Both	28	17%
Barrhill_5a.1	Mottled Immature Pallic Soils (PIM)	Stonless Soil	Silt over sand	Both	7	4%
Barrhill_6a.1	Typic Immature Pallic Soils (PIT)	Stonless Soil	Loam over silt	North	2	1%
Templeton_1a.1	Typic Immature Pallic Soils (PIT)	Moderately deep soil	Loam over silt	North	26	16%
Templeton_3a.1	Typic Immature Pallic Soils (PIT)	Stonless Soil	Silt	North	3	2%
Flaxton_4a.1	Typic Immature Pallic Soils (PIT)	Stonless Soil	Silt	North	18	11%
Temuka_18a.1	Typic Orthic Gley Soils (GOT)	Stoneless soil	Silt over clay	South	18	11%
Total					160.05	100%

Support Block - East						
Family /Sibling	Soil Classification	Soil Profile Material	Profile Texture	Location	Area - ha	Percentage
Templeton_1a.1	Typic Immature Pallic Soils (PIT)	Stonless Soil	Silt	East	9.7	61%
Wakabui_3a.1	Mottled Immature Pallic Soils (PIM)	Stonless Soil	Silt over sand	East	2	13%
Templeton_2a.1	Typic Immature Pallic Soils (PIT)	Moderately deep soil	Silt	East	2	13%
Eyre_1a.1	Weathered Orthic Recent Soils (ROW)	Rounded stony soil	Silt	East	1	6%
Templeton_3a.1	Typic Immature Pallic Soils (PIT)	Stonless Soil	Silt	East	1	6%
Templeton_4a.1	Typic Immature Pallic Soils (PIT)	Moderately deep soil	Silt	East	0.1	1%
Wakanui_21a.1	Mottled Immature Pallic Soils (PIM)	Moderately deep soil	silt over sand	East	0.1	1%
Eyre_3a.1	Weathered Orthic Recent Soils (ROW)	Rounded stony soil	Silt	East	0.1	1%
Total					16	100%

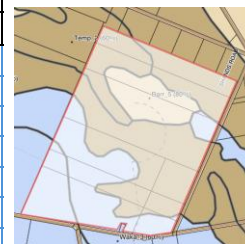

Class	Description	Area
Blue	Poorly drained	38ha
Light Blue	Imperfectly drained	38ha
Brown	Moderately well drained	2ha
Yellow	Well drained	< 1ha
Grey	Unclassified Land	0ha
White	Water	< 1ha

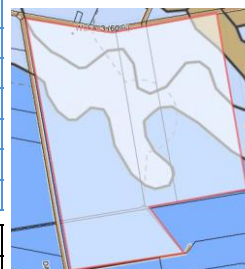

Disclaimer - Report statistics are estimated from all siblings in the selected area - including the non-dominant siblings in each soil polygon.

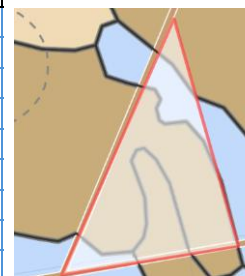

Reference:

<https://smap.landcareresearch.co.nz/maps-and-tools/app>

